

**Floor Finish Notes:**

- Proprietary aluminum threshold matching overall door frame dimension between VL2 and CM2.
- 地板饰面注释:
- 专有铝门槛, 与VL2和CM2之间的整体门框尺寸相匹配

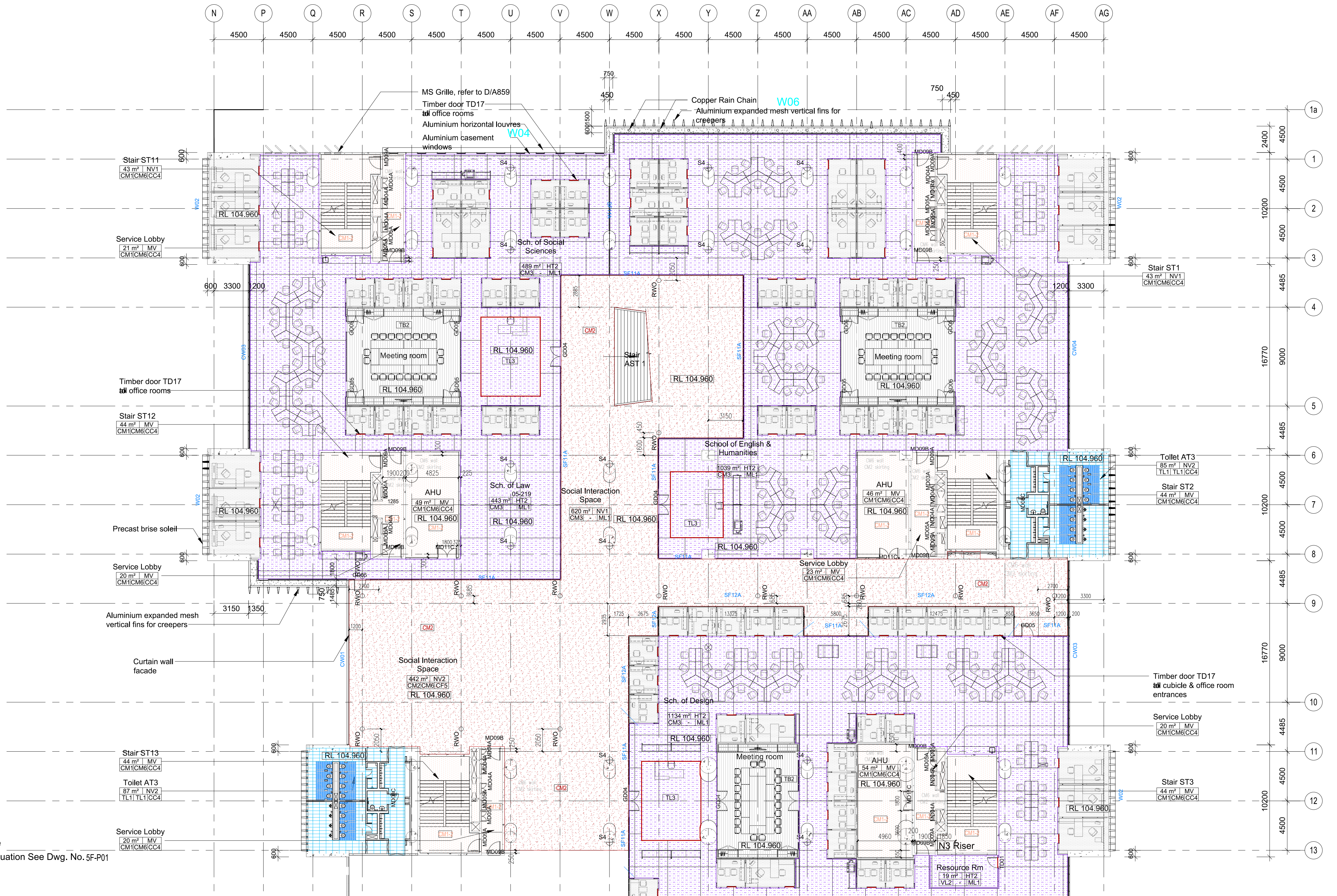

<input type="checkbox"/> Review completed, subject to any further sample or mock-up requirements
<input type="checkbox"/> Received only
<input type="checkbox"/> Resubmit
<input type="checkbox"/> Make corrections noted
<input type="checkbox"/> Rejected

The shop drawings are reviewed for conformance with architectural design & concept. The review does not relieve the contractor of responsibility to:

- Ensure correctness of dimensions, quantities, calculations, construction and fabrication techniques.
- Comply with the specification. Any deviation must be clearly highlighted in writing for acceptance.
- Coordinate the works of all parties involved.
- Satisfy any further requirements noted on the drawings or other contract documents.
- Comply with other consultant's requirements & specifications.

WOHA	
By	Date

**FINISHES SCHEDULE LEGEND**

CM1	Cement and Sand screed	VL2	SOLID COLOUR LINOLEUM 纯色胶地板
CM1-1	Cement and Sand screed	TL1	HOMOGENEOUS TILES 通体砖
CM1-2	Cement and Sand screed	TR2-1	ENGINEERED TIMBER PLANKS 成品复合木板
CM2	Slip Resistant Tiles		3T ALUM DIVIDERS 3mm厚铝制分隔条
CM3	Slip Resistant Tiles		

**5th Floor & Wall Finishes Schedule (West Wing)**  
1 : 200

- Notes:**
- All stairs, elevators, escalators and risers are decorated as shown in the relevant drawings. 所有楼梯、电梯、扶梯及管井装饰做法详见相关详图。
  - The slash fill area is not within this scope and is detailed on the associated drawings. 填充区域不在本次范围, 详见相关图纸。
  - All Terrazzo finish area will need skirting to be finish (H=150mm). 所有水磨石饰面区域都需要踢脚线进行饰面(高150mm)。
  - All risers wall finishes can be in CC4 finish if concrete wall. If masonry wall is use, CM6 shall apply. 所有管井当为混凝土墙面时, 采用CC4饰面; 如为砌体墙时, 则采用CM6饰面

© WOHA Pte Ltd 2015. All rights reserved.	<b>WOHA DESIGNS PTE LTD</b> 29 hongkong street singapore 059919 t: +65 6423 4555 f: +65 6423 4666 e: admin@woha.net	<b>Web Structures Pte Ltd</b> 40 Carpenter Street, Singapore 059919 t: +65 6223 9208 f: +65 6220 7928 e: webstruc@webstruc.net	<b>EMCS</b> House 7 (2ndFloor), Road 17, Nkunjing-2, Khalidat 1229 Dhaka Bangladesh t: +88 02 89009060 e: emcs_bd@yahoo.com	<b>BRACU New Campus</b> Manager: Eng. Md. Saifur Rahman B.Sc. Engg. (EEE), M.Engg. Signature: Eng. Dipko Masumder CAD Designer	<b>Transsolar Energietechnik GmbH</b> Landwehrstrabe 60/62 Munchen, D-80336 Germany t: +49 (89) 580 688-42 f: +49 (89) 590 688-59 e: kessling@transsolar.com	<b>BRAC University</b>	<b>5th Floor &amp; Wall Finishes Schedule (West Wing)</b>	<b>ASSOCIATED BUILDERS CORPORATION LTD</b> ABC HOUSE (7th floor), B.Banani C/A, Kemal Ataturk Avenue Dhaka 1213 Tel: 9821291-2, 58814620, 9861935, 9862665	<b>BEIJING URBAN CONSTRUCTION GROUP CO., LTD</b> Chengjian Plaza, Beijing, P.R.China Tel: 0086-10-62091714 Web: english.bucg.com	<b>Contractor</b> <b>BUCC-ABC JOINT VENTURE</b>	SCALE: 1:200 DATE: 20 Oct 2021 JOB NO.: 195 FILE NAME:	DATE: 20 Oct 2021 CHECKED BY: LL	Amendments By: WJ Date: 05 Dec 2020	DRAWING NO.: <b>5F-P02</b> Ref C/A067_F	REV: C PURPOSE OF DRAWING: Shop Drawing
---	---	---	---	--	--	------------------------	---	--	--	--	---	-------------------------------------	---	--	--